

BERGO BASE CABINET LEG

With Leg Adjuster

BERGO®

The Bergo base cabinet leg is a component of a comprehensive system designed for cabinets. Its legs are constructed from a thermoplastic material that offers high shock resistance, excellent dimensional stability, and long-lasting durability. These legs also provide strong mechanical and chemical resistance.

Assembly Specifications

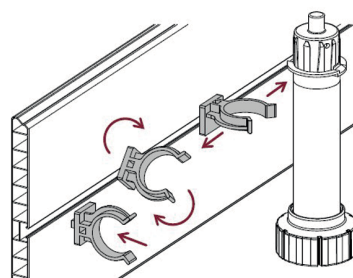
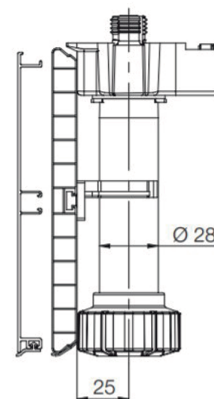

Profile Description

Material:	PVC
Finish/Colour:	Black
Specifications:	Thermoplastic shock-proof material. High dimensional stability and inalterability in time. Strong chemical and mechanical resistance.

Item ID No.

Item	Length mm	Cat. No.
PVC leg	100	BG-600.02.040
	150	BG-600.02.041
Leg Adjuster	-	BG-601.02.040

TDS-BG-600.02.040.v24.1