

The quickest method for assembling wooden panels and solid wood reliably and securely.

They are very commonly used in furniture making and construction.

Made from dried beech wood. Its two chamfered ends perfectly fit into corresponding holes of two workpieces that are to be joined and, in combination with glue it provides a strong and durable connection.

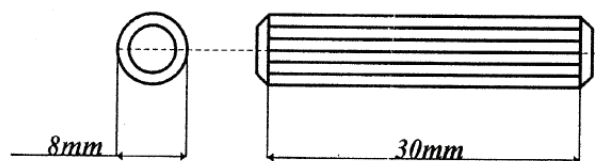

°45 chamfered ends
for easier insertion

Description

Material:	Beech
Species:	Fagus sylvatica
Diameter:	8 mm
Length:	30 mm
Tolerance:	Pins have ± 0.1 mm of tolerance in both length and diameter

Item ID No.

Item	Cat. No.
Beech wooden dowel Ø8x30mm	BG-220.06.060



Quality
Made in Italy



Environmental friendly
- from an FSC source